

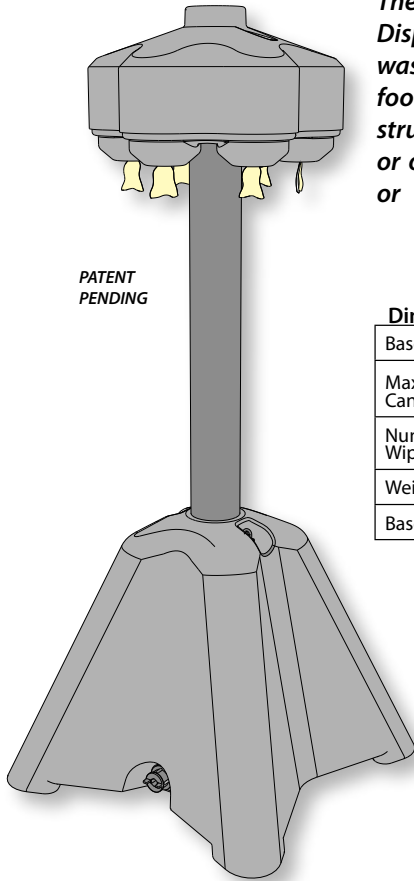

SAN1-1000 Sani-Stand™ Hand Wipes Dispenser Assembly Instructions

General Overview

The SAN1-1000 - Sani-Stand™ Hand Wipes Dispenser is designed for use where hand washing is not available such as festivals, food service locations, petting zoos, construction sites, etc., to be used indoors or out. The base can be filled with water or sand to provide additional stability.



Specifications

Dimension	Imperial	Metric
Base/Holder/Lid/Pipe	28"x28"x66"	71x 71x168 cm
Maximum Hand Wipes Canister Capacity	6/220 count	
Number of Single Wipe Dispenses	1320-6/220 count 6"x7.5" individual wipe size	
Weight Empty	27.5 lb	12.5 kg
Base Capacity	23 gal	87.1 ltr

~~Assembly Tools Required~~

- *Drill with a Phillips Bit
or a Phillips Head Screwdriver*

POLYJOHN USA

PolyJohn Enterprises Corp
2500 Gaspar Ave.
Whiting, IN 46394
Phone: 800-292-1305
Fax: 219-659-0625
www.polyjohn.com
info@polyjohn.com

POLYJOHN WORLDWIDE

PolyJohn (UK) Ltd.
Equinox 1 Audby Lane
Wetherby, England LS22 7RD
Phone: 44 (0) 1937-583333
Fax: 44 (0) 1937-583322
sales@polyjohn.co.uk

POLYJOHN CANADA

Rama Plastics
P.O. Box 2300
199 Forest Plain Rd.
Orillia, Ontario LV3 6S2
Phone: 800-465-9590
Fax: 705-325-8250
info@ramaplastics.ca

Full Scale Fastener Drawing



(2) PC-000158
Self-Tapping Screw

Exploded View

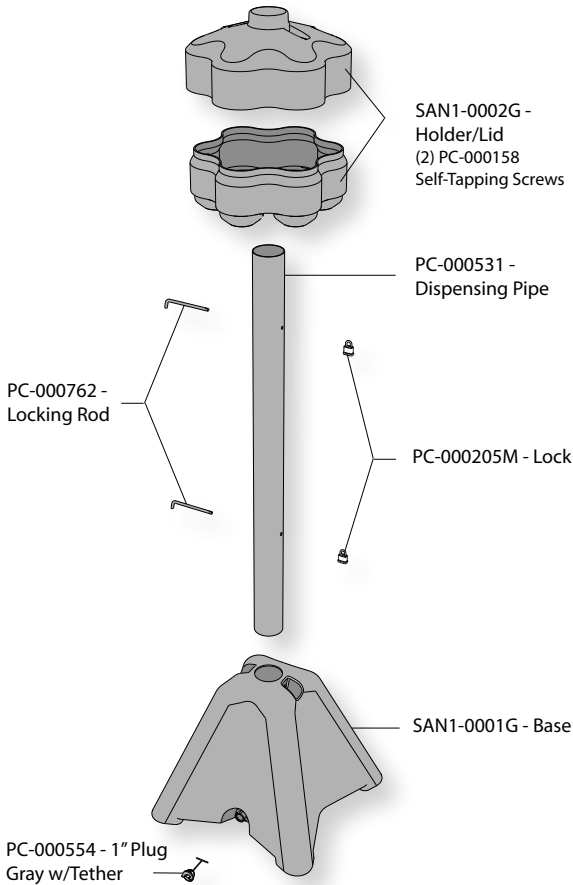

*The recommended Hand Wipe product to use would be the **Rid-It® SAN1-0220 - Sani-Hands® II Wipes**, a 220 count wipes canister. This product contains 65.9% SD Alcohol by volume for antiseptic purposes, yet gentle on hands because it also contains a moisturizer to help keep the skin from drying out. **The FDA recommends an alcohol based product to be 60-95% in content when hand washing is unavailable to help prevent the spread of germs.** However, other hand sanitizing wipes may be used.*

Assembly Instructions

Step 1. Insert the PC-000531 - Dispensing Pipe into the SAN1-0001G - Base.

Step 2. Line up the pre-drilled holes of the base and dispensing pipe. Insert a PC-000762 - Locking Rod through the holes of the base and dispensing pipe and push through to the other side. Place a PC-000205M - Lock onto the locking rod and secure in place.

Step 3. Insert a locking rod through the top hole of the pipe and push through to the other side. Place a lock onto the locking rod and secure. Place the SAN1-0002G - Holder/Lid Dispensing Container onto the dispensing pipe (*making sure the groove on the bottom side of the container is resting on the locking rod.*)

Step 4. While pushing down on the top of the dispenser, drive (2) PC-000158 Self-Tapping Screws through the two drill spots located on the lid and through the dispensing pipe.

General Use and Information

Filling the Base:

To fill the base with water or sand (*in order to create enough ballast to keep from being tipped over*), unlock the lock from the base and remove the lock, locking rod and dispensing pipe. Fill with either water or sand and reinsert the locking rod and lock.

Note: *When filling with sand, make sure to tilt the base on its side to keep the bottom raised area free from sand for proper installation of the dispensing pipe into the base.*

Draining the Base:

To drain the base if filled with water, simply loosen the PC-000554 Plug located at bottom of the base. Hand tighten the plug when finished draining. If filled with sand, unlock the lock, remove the lock and locking rod and pull out the dispensing pipe. Turn the base upside down and empty. Reinsert the dispensing pipe, locking rod and lock when empty.

Filling the Dispenser:

To fill the dispenser, unlock the lock from underneath the Holder/Lid Dispensing Container and remove the lock and locking rod.

Note: *The force of the weight of the wipes canisters being full will enable the bottom of the Holder/Lid Dispensing Container to pull down almost by itself. When empty you will have to pull down with some effort.*

Remove the lids from the **SAN1-0220 - Sani-Hands® II Wipes**, and discard the seals. Thread the first wipe through the hole of the lid (*follow the instructions on the wipes canister label*). Place the lids back on the canisters and leave the caps open. Place the canisters upside down into the holder with the caps facing the dispensing pipe. Push the holder up into the lid (*make sure the groove on the bottom side of the holder lines up with the pre-drilled holes in the pipe*).

Insert the locking rod through the hole of the dispensing pipe underneath the Holder/Lid and push through to the other side and secure the lock.

Note: *It is suggested to close the caps of the wipes canisters if they will not be in use for a prolonged period of time.*

CLEANING AND MAINTENANCE

Use a mild soap to clean all surfaces and component parts.

Minor scratches and abrasions can be lightly sanded or scrubbed with a mild abrasive cleaner (*such as "Soft Scrub"*) that contains calcium carbonate, hypochlorate bleach and detergents. Be sure to follow the cleaning product directions since these ingredients may cause hazardous gases when mixed with other chemicals. Rinse the cleaned area and buff with a conventional wax.

Some light scratches may also be hidden by using an industrial hot air gun.

For a source of cleaning, deodorizing and paper products contact:

**RID IT
2500 GASPAR AVE.
WHITING, IN 46394-2175
800-292-1305 EXTENSION 514
www.rid-it.com**

We highly recommend membership in the Portable Sanitation Association International (PSAI); the worldwide authority on portable sanitation services. The PSAI, "Portable Sanitation Industry Certification Program" manual contains a wealth of information on standards and service procedures. For more information contact the PSAI:

PORTABLE SANITATION ASSOCIATION INTERNATIONAL (PSAI)
7800 METRO PARKWAY, SUITE 104
BLOOMINGTON, MINNESOTA 55425 USA
800-822-3020 / 612-854-8300 FAX 612-854-7560
www.pesai.org

MISSION STATEMENT

"PolyJohn is a family owned, state of the art, plastics manufacturing company dedicated to providing its employees with a work environment committed to excellence, and its customers with innovative products, services and technology that meet or exceed their requirements."

THANK YOU FOR PURCHASING POLYJOHN PRODUCTS!

Look for us on the Web @ www.PolyJohn.com